

## Shell Kit Aqualift S Compact tileable GTF500 Duo

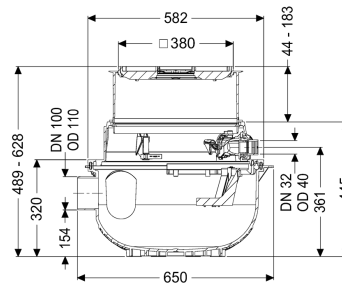

### Article information

Item no.: 280510X-RBK

GTIN: 4026092106938

Price group: 20

### Description

For combination with a KESSEL technology kit for creating a Duo lifting station for wastewater without sewage with a GTF500 wastewater pump.

The ready to plug in lifting station for wastewater without sewage is equipped with a submersible pump and a backflow preventer. The collection tank made of permanently resistant polymer (PE) has an open pump tank. One-handed closures enable easy removal of the integrated components. The system for installation in the floor slab is pre-assembled for final installation on site.

### KESSEL shell kit consisting of:

- With vertically adjustable upper section for continuous height and level compensation and integrated floor drain
- PE collection tank, resistant to aggressive wastewater and 3 m groundwater
- Includes backflow preventer for the pressure pipe
- Includes connection socket for inlet and conduit pipe

### Variant

|                 |              |
|-----------------|--------------|
| Type of system: | duo pump     |
| Pump control:   | Float switch |

### General characteristics

|                     |                |
|---------------------|----------------|
| Colour:             | black          |
| Standard:           | EN 12050-2     |
| Type of wastewater: | without sewage |

|  |   |
|--|---|
| Installation situation:                                | floor slab installation   |
| Delivery state:  | Installation-ready (connection parts must be connected on site) |
| Dimensions   |   |
| Net weight:  | 16,2 kg   |
| Gross weight:  | 16,2 kg   |
| Groundwater resistant from lower edge of base section: | 3000 mm   |
| Installation depth:                                    | 490 - 620 mm  |
| Type of height adjustability:                          | vertically adjustable upper section                             |
| Length:  | 617 mm  |
| Width:   | 585 mm  |
| Packaging dimension:                                   | length  |
| Packaging dimension:                                   | width   |
| Packaging dimension:                                   | height  |
| Tank/drain body  |   |
| Pressure pipe connection (DN):                         | 32  |
| Pressure pipe connection (OD):                         | 40 mm   |
| Inlet nominal size (DN):                               | 100 mm  |
| Pumping volume:  | 16 l  |
| Tank volume:   | 65 l  |
| Coverage features                                      |   |
| Type of cover:   | tileable cover plate  |
| Cover material:  | Polymer   |
| Colour of cover:                                       | grey  |
| Width of cover:  | 366 mm  |
| Length of cover:                                       | 366 mm  |
| Drainage function:                                     | yes   |
| Locking:   | Lock & Lift   |
| Load class:  | K 3 (EN 1253-1)   |
| Max. flooring height:                                  | 16 mm   |
| Pumping device   |   |
| Pump:  | GTF 500   |
| Number of pumps:                                       | 2   |
| Operating voltage:                                     | 230 V   |
| Max. pumping height:                                   | 8 m   |
| Control  |   |
| Operating voltage:                                     | 230 V   |