

Shell Kit Aqualift S Compact tileable GTF1200 Duo

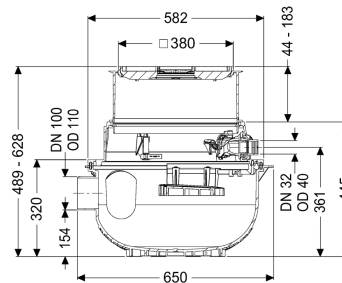

Article information

Item no.: 280511X-RBK

GTIN: 4026092106976

Price group: 20

Description

For combination with a KESSEL technology kit for creating a Duo lifting station for wastewater without sewage with a GTF1200 wastewater pump.

The ready to plug in lifting station for wastewater without sewage is equipped with a submersible pump and a backflow preventer. The collection tank made of permanently resistant polymer (PE) has an open pump tank. One-handed closures enable easy removal of the integrated components. The system for installation in the floor slab is pre-assembled for final installation on site. The station is controlled by a user-friendly control unit, which is optionally integrated in the building management system using a potential-free contact or alarm and collective fault messages that can be output through a GSM interface.

KESSEL shell kit consisting of:

- With vertically adjustable upper section for continuous height and level compensation and integrated floor drain
- PE collection tank, resistant to aggressive wastewater and 3 m groundwater
- Includes backflow preventer for the pressure pipe
- Includes connection socket for inlet and conduit pipe

Variant

| | |
|-----------------|--------------|
| Type of system: | duo pump |
| Pump control: | Float switch |

General characteristics

| | |
|-------------------------|---|
| Colour: | black |
| Standard: | EN 12050-2 |
| Type of wastewater: | without sewage |
| Installation situation: | floor slab installation |
| Delivery state: | Installation-ready (connection parts must be connected on site) |

| | |
|--|-------------------------------------|
| Dimensions | |
| Net weight: | 16,5 kg |
| Gross weight: | 16,5 kg |
| Groundwater resistant from lower edge of base section: | 3000 mm |
| Installation depth: | 490 - 620 mm |
| Type of height adjustability: | vertically adjustable upper section |
| Length: | 617 mm |
| Width: | 585 mm |
| Packaging dimension: | length |
| Packaging dimension: | width |
| Packaging dimension: | height |

| | |
|--------------------------------|--------|
| Tank/drain body | |
| Pressure pipe connection (DN): | 32 |
| Pressure pipe connection (OD): | 40 mm |
| Inlet nominal size (DN): | 100 mm |
| Pumping volume: | 20 l |
| Tank volume: | 65 l |

| | |
|-----------------------|--------------------------------|
| Coverage features | |
| Type of cover: | Cover plate with slotted cover |
| Cover material: | Polymer |
| Colour of cover: | black |
| Width of cover: | 366 mm |
| Length of cover: | 366 mm |
| Drainage function: | yes |
| Locking: | Lock & Lift |
| Load class: | K 3 (EN 1253-1) |
| Max. flooring height: | 16 mm |

| | |
|----------------------|----------|
| Pumping device | |
| Pump: | GTF 1200 |
| Number of pumps: | 2 |
| Operating voltage: | 230 V |
| Max. pumping height: | 9 m |

| | |
|--------------------|-------|
| Control | |
| Operating voltage: | 230 V |