

Lifting station Aqualift F Comp. Duo, SPZ 1000, res., Floor sl., tileable

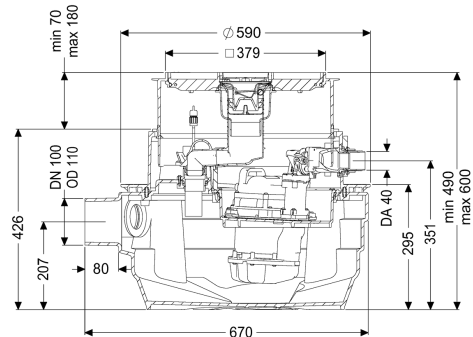

Article information

Item no.: 28704XC
 GTIN: 4026092093665
 Price group: 20

Advantages

- Suitable for complete basement drainage
- Integrated drainage function when installed in the floor slab
- Maximum operating reliability due to intelligent control unit (Duo)

Description

The lifting station for faecal and faecal-free wastewater is equipped with one or two submersible pumps and a backflow preventer. The collection tank made of permanently resistant polymer (PE) has an enclosed pump tank. One-handed closures enable easy removal of the integrated components.

Variant

Type of system:

Shut-off valve:

Resistant:

Pump control:

Backflow preventer:

Pressure pipe connection:

duo pump

without shut-off valve

Resistant to waste water containing salt, softener and condensate

Control unit

integrated

horizontal

General characteristics

Colour:

Type of wastewater:

Installation situation:

Delivery state:

black

with sewage

floor slab installation

Pre-mounted for final assembly on site (pumps and sensor system must be fitted on site and control unit must be connected)

| | |
|--|-------------------------------------|
| Approval: | Z-53.2-484 |
| System type: | Duo |
| Dimensions | |
| Net weight: | 42,5 kg |
| Gross weight: | 47,5 kg |
| Groundwater resistant from lower edge of base section: | 3000 mm |
| Cutout dimension, width: | 800 mm |
| Cutout dimension, length: | 800 mm |
| Installation depth: | 490 - 600 mm |
| Type of height adjustability: | vertically adjustable upper section |
| Length: | 670 mm |
| Width: | 590 mm |
| Packaging dimension: | length |
| Packaging dimension: | width |
| Packaging dimension: | height |
| Tank/drain body | |
| Pressure pipe connection (DN): | 32 |
| Pressure pipe connection (OD): | 40 mm |
| Connection conduit pipe (DN): | 50 |
| Venting connection (DN): | 70 |
| Distance from centre of outlet pipe to tank bottom: | 351 mm |
| Distance pipe bottom outlet to tank bottom: | 351 mm |
| Distance pipe bottom inlet to tank bottom: | 152 mm |
| Distance from centre of inlet pipe to tank bottom: | 207 mm |
| Inlet nominal size (OD): | 110 mm |
| Inlet nominal size (DN): | 100 mm |
| Number of inlets: | 1 |
| Pumping volume: | 20 l |
| Tank volume: | 40 l |
| Coverage features | |
| Type of cover: | tileable cover plate |
| Cover material: | Polymer |
| Width of cover: | 366 mm |
| Length of cover: | 366 mm |
| Drainage function: | yes |
| Locking: | Lock & Lift |
| Max. flooring height: | 16 mm |
| : | |
| Pumping device | |
| Pump: | SPZ 1000 resistant |
| Number of pumps: | 2 |
| Weight, pump: | 10 kg |

| | |
|--|--|
| Connection type: | coded plug |
| Protection class: | I |
| Insulation class: | F |
| Cos phi - power factor: | 0,97 |
| Protection class (pump): | IP 68 |
| Temperature monitoring: | integrated |
| Max. temperature (permanent) of conveyed material: | 40 °C |
| Hot water resistance for a short time (2 min): | 80 °C |
| Max. pumping capacity: | 11,5 m³/h |
| Max. pumping height: | 10 m |
| Speed: | 2800 U/min |
| Power P1: | 1,2 kW |
| Power P2: | 0,69 kW |
| Operating mode: | S3 - 50 % |
| Type of pump connection cable: | H07RN-F 3G 1.5 mm² |
| Impeller type: | Macerator |
| Length of mains cable for pump: | 5 m |
| Rated current: | 5,2 A |
| Control | |
| Control unit: | Comfort |
| Control unit function: | With alarm message |
| Motor protection switch: | yes |
| Alarm sensor: | optical probe |
| Level measurement instrument: | Immersion pipe |
| Type of level measurement: | pneumatic |
| Protection class control unit: | IP 54 |
| Mains frequency: | 50 Hz |
| Operating voltage: | 230 V |
| Connection type: | coded plug |
| Length of mains cable for control unit: | 1,4 m |
| Potential-free contact: | optional |
| GSM interface: | yes |
| USB interface: | yes |
| Log book function: | yes |
| Multi-line display: | yes |
| Battery buffering: | yes |
| Self-diagnosis system (SDS): | yes |
| Warning equipment version: | acoustic and optical signal |
| Type of fuse required (control unit): | Fuse protection through control unit 230 V |