

Shower channel Linearis Compact L: 450 mm, DN 50, WaD, 304 SST cov., K 3

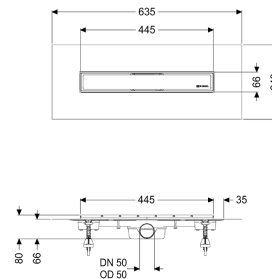
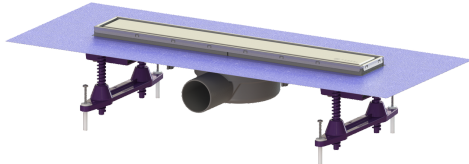

Article information

Item no.: 45600.60M
GTIN: 4026092078884
Price group: 10

Advantages

- Individual design with reversible stainless steel insert
- Low installation depth
- Highest fire protection standards

Description

The Linearis Compact shower channel with welded on drain body made of ABS is suitable for indoor linear drainage. If inserted upside down, the stainless steel insert can be tiled individually. Including prepared seepage water openings and odour trap.

Variant	
System:	125
Seepage opening:	prepared
Waterproofing layer on the upper section:	Factory-fitted sealing collar (WaD) according to DIN 18534
Water exposure class in accordance to DIN 18534-1 (up to and including):	W3-I
Sealing water height:	22 mm
Discharge rate (l/s) with 10 mm threshold:	0,6
Discharge rate (l/s) with 20 mm threshold:	0,7
Discharge rate (l/s) without threshold:	0,5 mm
General characteristics	
Nominal size (DN):	50
Outer diameter (OD):	50 mm
Odour trap:	included

Dimensions

Net weight:	1,34 kg
Gross weight:	1,89 kg
Outer dimension, length:	515 mm
Installation depth:	80 - 140 mm
Width:	191 mm
Height:	80 mm
Packaging dimension:	length
Packaging dimension:	width
Packaging dimension:	height
Tank/drain body	
Number of outlets:	1
Material of drain body:	ABS
Coverage features	
Type of cover:	Stainless steel cover
Cover material:	Stainless steel 14301
Colour of cover:	silver
Surface:	Brushed SST
Frame material:	Stainless steel 14301
Load class:	K 3 (EN 1253-1)
Grating design:	optionally tileable
Rim width:	66 mm
Rim length:	450 mm
Max. flooring height:	15 mm
Shape of upper section:	square
Upper section material:	ABS